

MULTI-POWER CNC PRECISION FIXED ANGLE VISE

Model: HPAC-100S, 130S, 160S

PATENTED
142711
M224615
M287204
M344941

- Shortest Length with Big Jaw Opening
- Extremely High Accuracy and Repeatability
- Special MULTI-POWER design enhances clamping force of **0 ~ 6000KG**

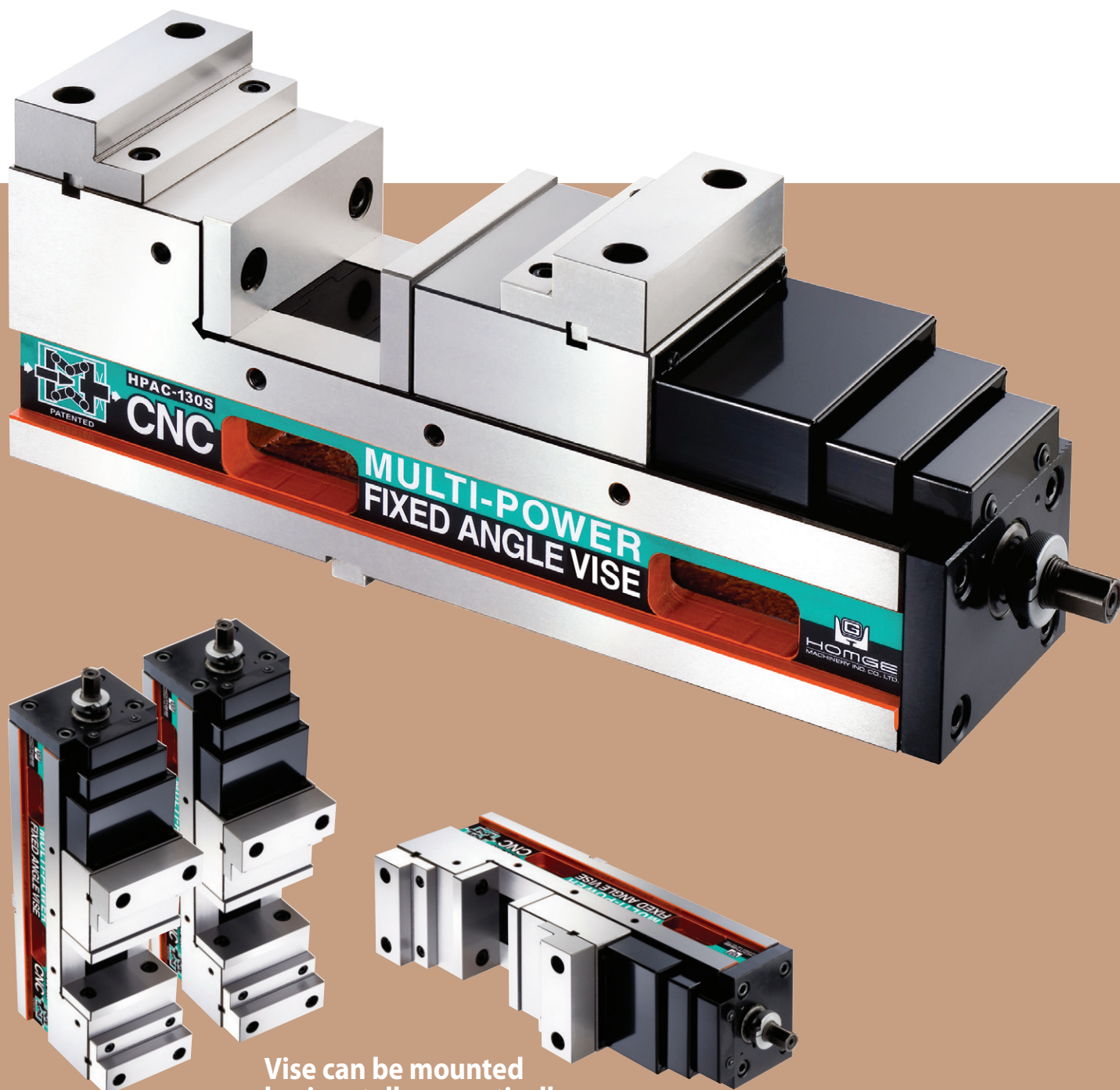

Vise can be mounted
horizontally or vertically.

PATENTED
142711
M224615
M287204
M344941

MULTI-POWER CNC PRECISION FIXED ANGLE VISE

Model: HPAC-100S, 130S, 160S

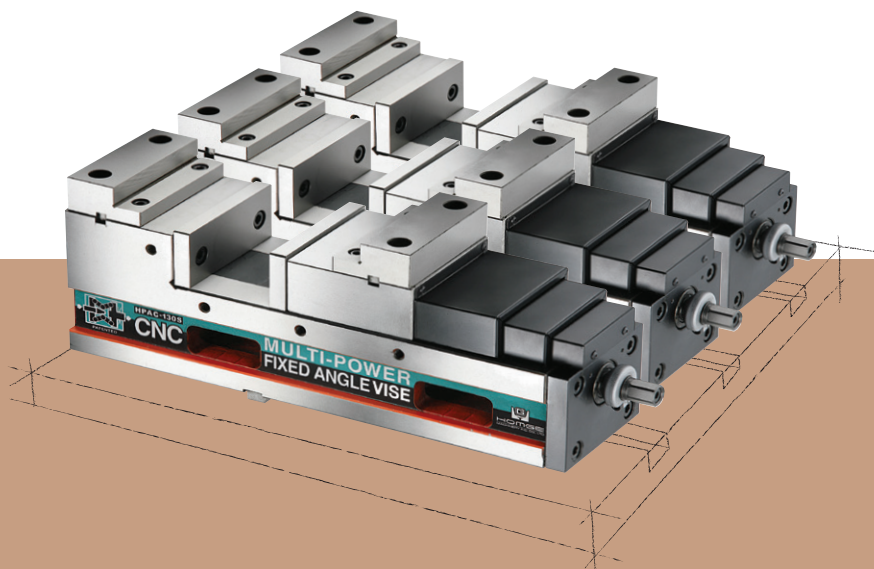
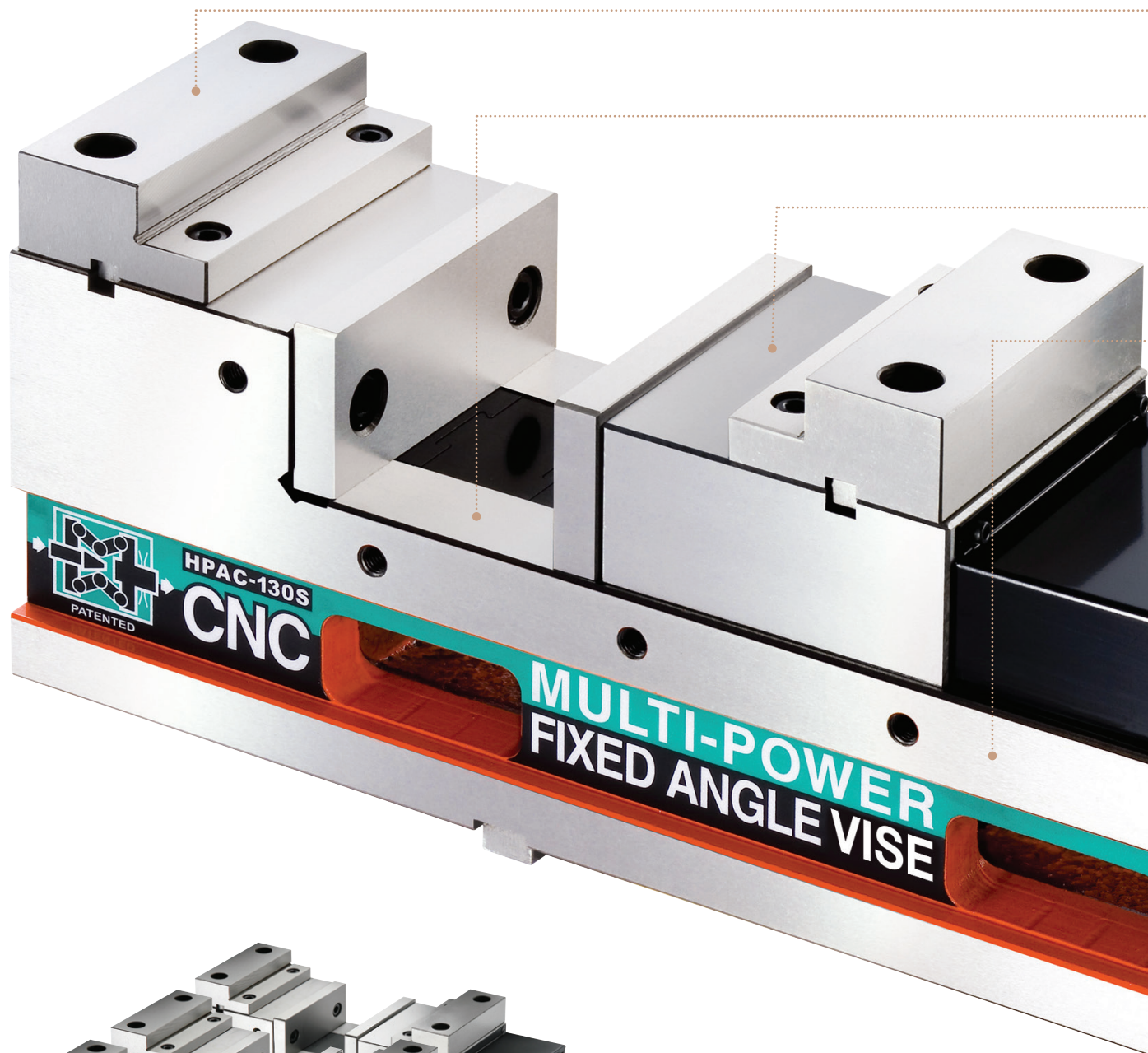

*Fixed height
Special for*

1. The patented MULTI-POWER SYSTEM is built of **HIGH GRADE BEARING STEEL** which doubles the clamping force. Adjustable clamping force of **0~6000kg**. With this special patented system the clamping force remains the same.

2. Slide ways are **HARDENED** to **HRC 50°** to further increase durability and maintain positioning height over long use.

3. Using high-grade iron of over FCD 60 grade for high rigidity and also **ANGLE-LOCK SYSTEM**, which automatically pulls the work-piece down to the accurate position of within 0.01mm under 4500kg of pressure, this vise is most suitable for precision mould making on Machining Centers.

4. Vise body is made of **Ductile Iron** above **FCD 60** grade for high precision and durability. It is made in one solid piece and has very high rigidity with a force of 4500kg, the shape will deflect less than 0.01mm.

5. Vise can be mounted horizontally or vertically.

6. Adjusting stop ring: this simple and effective presetting device enables to **preset each desired clamping force** and it guarantees to repeat each clamping operation at the same clamping force.

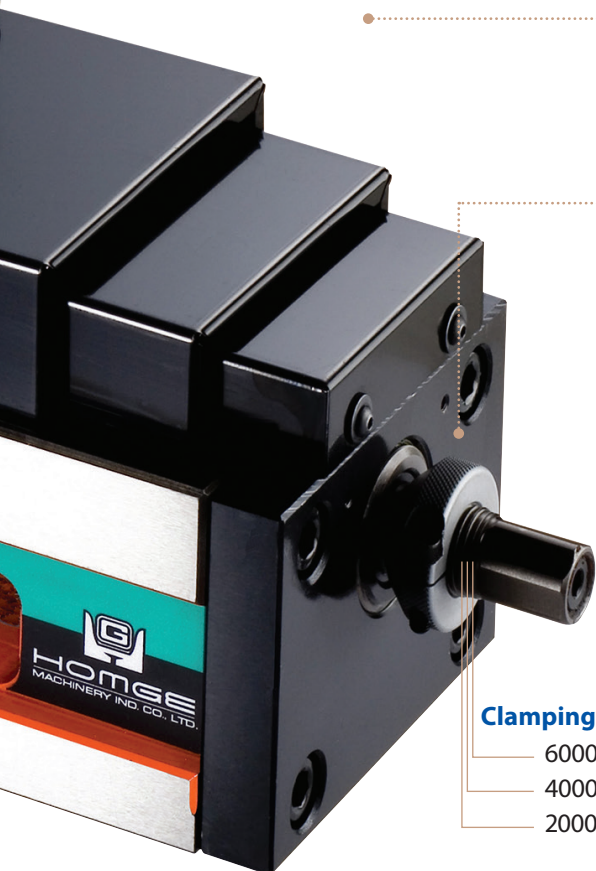

Clamping Force

- 6000 kg
- 4000 kg
- 2000 kg

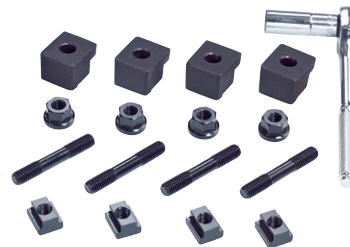

STANDARD ACCESSORIES

- 2 pcs of Alignment Wedge
- 4 pcs of Clamp
- 1 pc of Handle

OPTIONAL ACCESSORIES

- Cross Grooved Jaws
- "V" Jaws
- Combined Jaws
- Step Jaws



The patented MULTI-POWER SYSTEM built of **HIGH GRADE BEARING STEEL** provides extremely high clamping pressure. The pressure is more consistent and eliminates all leakage and maintenance problems associated with Hydraulic Vises.

so several vises can be used together.
High Speed CNC Machining Center

OPTIONAL ACCESSORIES:

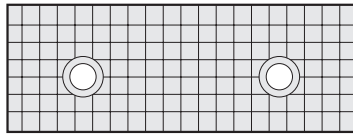

1) Cross Grooved Jaws

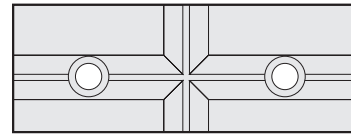

2) 'V' Jaws

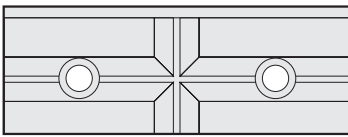

3) Combined Jaws

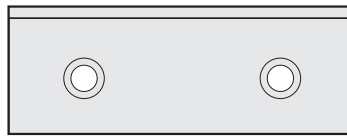

4) Step Jaws



DIMENSIONS

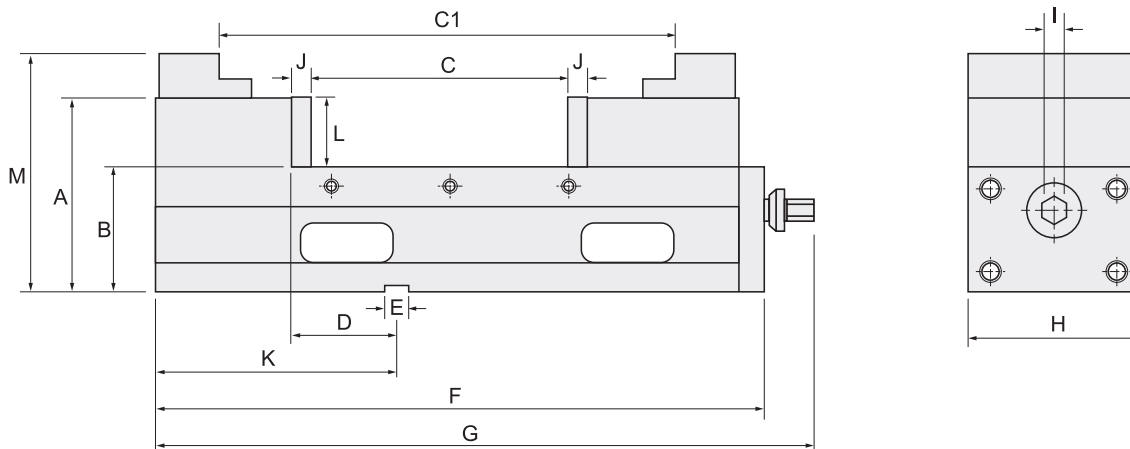

SPECIFICATIONS (Material: FCD 60 Ductile Iron, Hardness: HRC 50°)

Unit: mm

Model	A	B	C	C1	D	E	F	G
HPAC-100S	127	85 ± 0.01	0-170	115-280	75 ± 0.02	18	414	460
HPAC-130S	147	95 ± 0.01	0-190	155-340	75 ± 0.02	18	462	510
HPAC-160S	160	105 ± 0.01	0-300	190-450	80 ± 0.02	18	550	595
Model	Max. Clamping Force	H	I	J	K	L	M	Weight (kg)
HPAC-100S	4000kg	100	19	15	178	44	153	32
HPAC-130S	5000kg	131	19	15	178	55	181	46.5
HPAC-160S	6000kg	160	19	15	183	58	196	64