

X-AEWR

彩虹立銑刀頭
End Mills



----	精銑 Finishing
◎	中銑 Semi-finishing
◎	粗銑 Roughing

◎		乾式切削 Dry Machining
◎		油霧切削 MQL (Mist)
◎		水溶性切削 Emulsion Machining
----		油性切削 Oil Machining

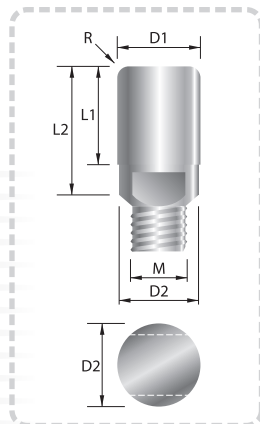

直徑 D1	R公差值 R Tolerance	直徑公差值 D1 Tolerance
8.0	+0.02 0	0 -0.02
10.0	+0.02 0	0 -0.02
12.0	+0.02 0	0 -0.02
16.0	+0.02 0	0 -0.02
20.0	+0.02 0	0 -0.02
25.0	+0.02 0	0 -0.03
32.0	+0.02 0	0 -0.04

unit : mm

型號 Type No.	D1 直徑 Diameter	L1 刃長 Flute Length	R 圓鼻角 Corner R	D2 頸徑 Neck Dia.	L2 全長 O.A.L.	M 螺牙 Thread Size	鎖固扳手型號 Screw Driver Type No.
X-AEWR0805	8.0	8.0	0.5	7.8	12.1	M 5 -3P	K08
X-AEWR0810	8.0	8.0	1.0	7.8	12.1	M 5 -3P	K08
X-AEWR1005	10.0	10.0	0.5	9.8	16.1	M 7 -3P	K10
X-AEWR1010	10.0	10.0	1.0	9.8	16.1	M 7 -3P	K10
X-AEWR1205	12.0	12.0	0.5	11.7	20.3	M 8 -3P	K12
X-AEWR1210	12.0	12.0	1.0	11.7	20.3	M 8 -3P	K12
X-AEWR1610	16.0	16.0	1.0	15.6	25.7	M10-3P	K16
X-AEWR1620	16.0	16.0	2.0	15.6	25.7	M10-3P	K16
X-AEWR1630	16.0	16.0	3.0	15.6	25.7	M10-3P	K16
X-AEWR2010	20.0	20.0	1.0	19.5	31.1	M12-3P	K20
X-AEWR2020	20.0	20.0	2.0	19.5	31.1	M12-3P	K20
X-AEWR2030	20.0	20.0	3.0	19.5	31.1	M12-3P	K20
X-AEWR2510	25.0	25.0	1.0	24.4	39.3	M16-3P	K25
X-AEWR2530	25.0	25.0	3.0	24.4	39.3	M16-3P	K25
X-AEWR3230	32.0	32.0	3.0	31.2	48.0	M20-3P	K32
X-AEWR3250	32.0	32.0	5.0	31.2	48.0	M20-3P	K32

unit : mm