

## X-GPR

石墨用圓鼻角立銑刀頭  
End Mills

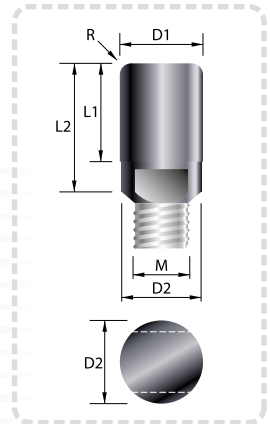

- 精銑  
Finishing
- 中銑  
Semi-finishing
- 粗銑  
Roughing
- 乾式切削  
Dry Machining
- 油霧切削  
MQL ( Mist )
- 水溶性切削  
Emulsion Machining
- 油性切削  
Oil Machining



型號 Type No.	D1 直徑 Diameter	L1 刃長 Flute Length	R 圓鼻角 Corner R	D2 頸徑 Neck Dia.	L2 全長 O.A.L.	M 螺牙 Thread Size	鎖固扳手型號 Screw Driver Type No.
X-GPR0805	8.0	8.0	0.5	7.8	12.1	M 5 -3P	K08
X-GPR0810	8.0	8.0	1.0	7.8	12.1	M 5 -3P	K08
X-GPR1005	10.0	10.0	0.5	9.8	16.1	M 7 -3P	K10
X-GPR1010	10.0	10.0	1.0	9.8	16.1	M 7 -3P	K10
X-GPR1210	12.0	12.0	1.0	11.7	20.3	M 8 -3P	K12
X-GPR1220	12.0	12.0	2.0	11.7	20.3	M 8 -3P	K12
X-GPR1610	16.0	16.0	1.0	15.6	25.7	M10-3P	K16
X-GPR1620	16.0	16.0	2.0	15.6	25.7	M10-3P	K16
X-GPR1630	16.0	16.0	3.0	15.6	25.7	M10-3P	K16

unit : mm