

X-UPR

高硬度用圓鼻角立銑刀頭
End Mills

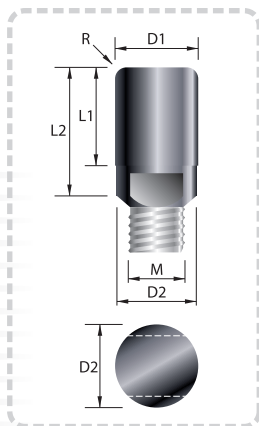

直徑 D1	R 圓鼻角 R Tolerance	直徑公差值 D1 Tolerance
8.0	+0.02 0	0 -0.02
10.0	+0.02 0	0 -0.02
12.0	+0.02 0	0 -0.02
16.0	+0.02 0	0 -0.02
20.0	+0.02 0	0 -0.03
25.0	+0.02 0	0 -0.04
32.0	+0.02 0	0 -0.04

unit : mm

型號 Type No.	D1 直徑 Diameter	L1 刃長 Flute Length	R 圓鼻角 Corner R	D2 頸徑 Neck Dia.	L2 全長 O.A.L.	M 螺牙 Thread Size	鎖固扳手型號 Screw Driver Type No.
X-UPR0805	8.0	8.0	0.5	7.8	12.1	M 5 -3P	K08
X-UPR0810	8.0	8.0	1.0	7.8	12.1	M 5 -3P	K08
X-UPR1005	10.0	10.0	0.5	9.8	16.1	M 7 -3P	K10
X-UPR1010	10.0	10.0	1.0	9.8	16.1	M 7 -3P	K10
X-UPR1210	12.0	12.0	1.0	11.7	20.3	M 8 -3P	K12
X-UPR1220	12.0	12.0	2.0	11.7	20.3	M 8 -3P	K12
X-UPR1610	16.0	16.0	1.0	15.6	25.7	M10-3P	K16
X-UPR1620	16.0	16.0	2.0	15.6	25.7	M10-3P	K16
X-UPR1630	16.0	16.0	3.0	15.6	25.7	M10-3P	K16
X-UPR2010	20.0	20.0	1.0	19.5	31.1	M12-3P	K20
X-UPR2020	20.0	20.0	2.0	19.5	31.1	M12-3P	K20
X-UPR2030	20.0	20.0	3.0	19.5	31.1	M12-3P	K20
X-UPR2050	20.0	20.0	5.0	19.5	31.1	M12-3P	K20
X-UPR2510	25.0	25.0	1.0	24.4	39.3	M16-3P	K25
X-UPR2520	25.0	25.0	2.0	24.4	39.3	M16-3P	K25
X-UPR2530	25.0	25.0	3.0	24.4	39.3	M16-3P	K25
X-UPR2550	25.0	25.0	5.0	24.4	39.3	M16-3P	K25
X-UPR3210	32.0	32.0	1.0	31.2	48.0	M20-3P	K32
X-UPR3230	32.0	32.0	3.0	31.2	48.0	M20-3P	K32
X-UPR3250	32.0	32.0	5.0	31.2	48.0	M20-3P	K32

unit : mm