

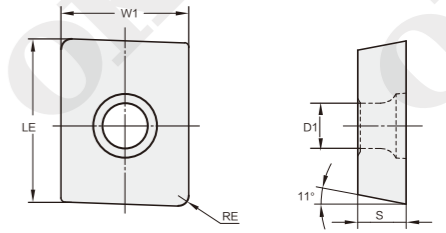

# 铣削刀片一览表 Milling Insert Overview

APKT-HT-Q1  P146	APKT-OPM  P146	APMT-ZM  P147	APMT-SDX  P147	APGT-NL  P147	APKT-NL  P147
RCKT-OPM  P148	RCKT-OPR  P148	RDMW-QBG  P148	RDKX-QBG  P148	RPEW-QBG  P149	RPMW-SD  P149
RPKT-SD  P149	RDMW-SD  P149	SDMT-OSM  P150	SDMT-ZDM  P150	SEET-QPF  P151	SEET-QPM  P151
SEET-QPR  P151	SEKT-NL  P151	SEET-OPF  P152	SEET-OPM  P152	SEET-OPR  P152	SEKN-Q  P152
SEKT-XM  P153	SEKT-OPM  P153	SNMX-OM  P154	SNMX-OR  P154	SPKN  P155	SPKR-YR  P156
SPMT090308  P157	SPMT-HT-1  P157	TPKN-Q1  P158	WPGT  P158		



刀片外形 Insert Shape	型号 Type	基本尺寸 Dimensions(mm)					涂层牌号 Grade				
		LE	W1	S	D1	RE	OP1215	OP1315	OP1325	OP1630	OP2202
	APKT150412-HT-Q1	15.875	12.7	4.76	5.4	1.2	●	▲			●
	APKT150412-OPM	15.875	12.7	4.76	5.4	1.2	●	▲			●

▲主推牌号 ●可选牌号 ▲Featured grade ●Optional grade

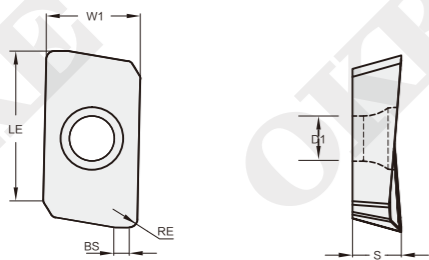

刀片外形 Insert Shape	型号 Type	基本尺寸 Dimensions(mm)					涂层牌号 Grade					
		LE	W1	S	D1	RE	OP1215	OP1315	OP1325	OP1630	OP2202	OK434
	APMT11T308-ZM	12.32	6.49	3.6	2.8	0.8			●	▲		
	APMT160408-ZM	17.56	9.5	5.76	4.4	0.8			●	▲		
	APMT1135PDER-SDX	11.39	6.2	3.5	2.8	0.8	●	▲			●	
	APMT1604PDER-SDX	17.12	9.2	4.76	4.4	0.8	●	▲			●	
	APGT1135PDER-NL	9.5	6.2	3.5	2.8	0.8						▲
	APKT160402-NL	16.3	9.525	4.76	4.4	0.2						▲

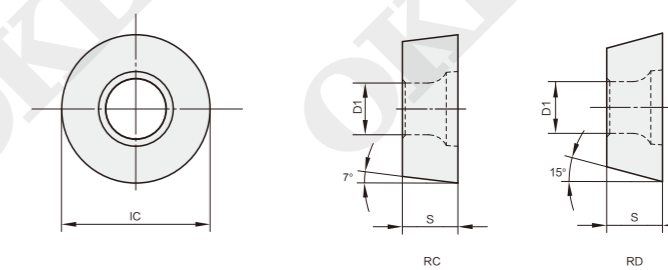

刀片外形 Insert Shape	型号 Type	基本尺寸 Dimensions(mm)			涂层牌号 Grade				
		IC	S	D1	OP1215	OP1315	OP1325	OP1630	OP2202
	RCKT1606MO-OPM	16	6.35	5.56	●	▲			●
	RCKT1204MO-OPR	12	4.76	4.4	●	▲			●
	RCKT1606MO-OPR	16	6.35	5.56	●	▲			●
	RDMW0803MO-QBG	8	3.18	3.4	▲	▲			●
	RDKW10T3MO-QBG	10	3.97	4.4	▲	▲			●
	RDKW1204MO-QBG	12	4.76	4.4	▲	▲			●
	RDKW1604MO-QBG	16	4.76	5.2	▲	▲			●
	RDKW1605MO-QBG	16	5.56	5.56	▲	▲			●
	RDKW2006MO-Q	20	6.35	6.55	▲	▲			●
	RDKX10T3MO-QBG	10	3.97	4.4	▲	▲			●
	RDKX1204MO-QBG	12	4.76	4.4	▲	▲			●
	RDKX1605MO-QBG	16	5.56	5.56	▲	▲			●

▲主推牌号 ●可选牌号 ▲Featured grade ●Optional grade

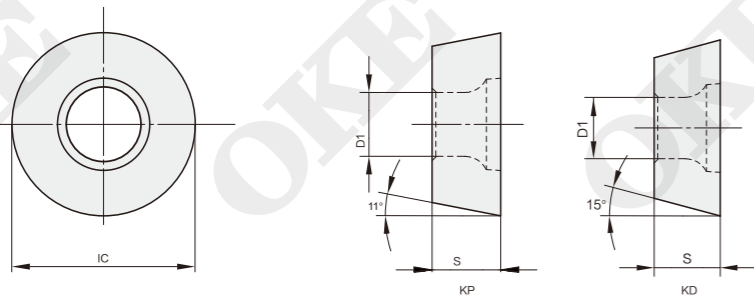

刀片外形 Insert Shape	型号 Type	基本尺寸 Dimensions(mm)			涂层牌号 Grade				
		IC	S	D1	OP1215	OP1315	OP1325	OP1630	OP2202
	RPEW0802MO-QBG	8	2.38	3.5	●	▲			●
	RPEW1003MO-QBG	10	3.18	4.6	●	▲			●
	RPMW1003MO-SD	10	3.18	4.6	●	▲			●
	RPKT1204MO-SD	12	4.76	4.4	●	▲			●
	RDMW0501MO-SD	5	1.59	2.0					▲
	RDMW0702MO-SD	7	2.38	2.8					▲
	RDMW0803MO-SD	8	3.22	3.4					▲
	RDMW10T3MO-SD	10	4.03	4.5					▲

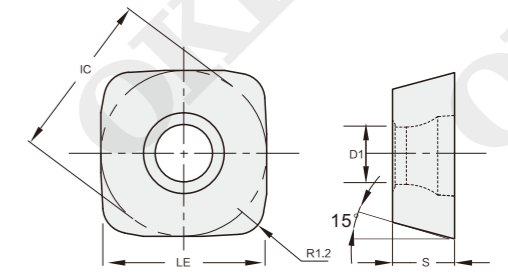

刀片外形 Insert Shape	型号 Type	基本尺寸 Dimensions(mm)						涂层牌号 Grade				
		IC	LE	D1	S	RE	$\alpha$	OP1215	OP1315	OP1325	OP1630	OP2202
	SDMT120412-OSM	12.7	12.7	4.4	4.76	2.0	15°	●	▲			●
	SDMT09T312-ZDM	9.525	9.525	4	3.97	1.2	15°	●	▲			●
	SDMT120412-OPM	12.7	12.7	4.4	4.76	2	15°	●	▲			●

▲主推牌号 ●可选牌号 ▲Featured grade ●Optional grade

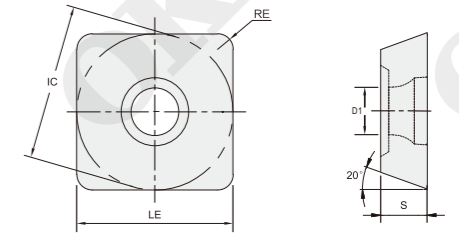
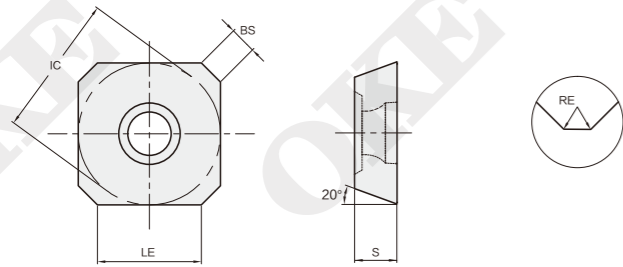

刀片外形 Insert Shape	型号 Type	基本尺寸 Dimensions(mm)					涂层牌号 Grade					
		LE	IC	S	D1	BS	OP1215	OP1315	OP1325	OP1630	OP2202	OK434
	SEET12T3-QPF	8.55	13.4	3.97	4.1	2.55	●	▲			●	
	SEET12T3-QPM	8.55	13.4	3.97	4.1	2.55	●	▲			●	
	SEET12T3-QPR	8.55	13.4	3.97	4.1	2.55	●	▲			●	
	SEKT1204-NL	9.3	12.7	4.76	5.6	2.01						▲

刀片外形 Insert Shape	型号 Type	基本尺寸 Dimensions(mm)					涂层牌号 Grade				
		LE	IC	S	D1	RE	OP1215	OP1315	OP1325	OP1630	OP2202
	SEET120308PER-OPF	13.29	13.29	4.042	4.1	R0.784	●	▲			●
	SEET120308PER-OPM	13.29	13.29	4.042	4.1	R0.784	●	▲			●
	SEET09T308PER-OPR	9.525	9.525	4.016	3.3	R0.786	●	▲			●

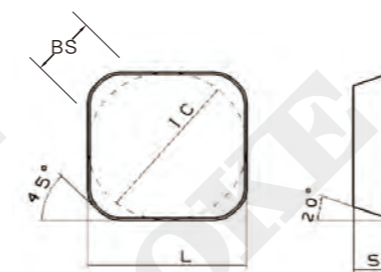

刀片外形 Insert Shape	型号 Type	基本尺寸 Dimensions(mm)					涂层牌号 Grade				
		LE	IC	S	D1	BS	OP1215	OP1315	OP1325	OP1630	OP2202
	SEKN1203AFTN	12.7	12.7	3.18		2.4	●	▲			●
	SEKN1504AFN-Q	15.875	15.875	4.76		2.45	●	▲			●

▲主推牌号 ●可选牌号 ▲Featured grade ●Optional grade

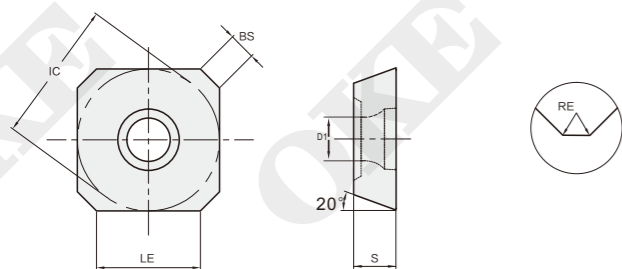

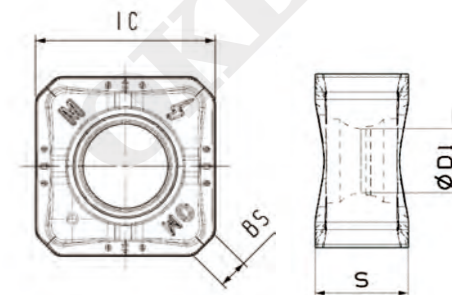

刀片外形 Insert Shape	型号 Type	基本尺寸 Dimensions(mm)				涂层牌号 Grade				
		IC	S	D1	BS	OP1215	OP1315	OP1325	OP1630	OP2202
	SEKT1204AFTN-XM	12.7	4.76	5.5	2.1	●	▲			●
	SEKT1204-OPM	12.7	4.76	5.6	2.1	●	▲			●
	SEKT1204-OPR	12.7	4.76	5.6	2.1	●	▲			



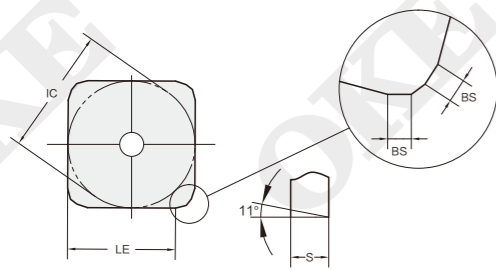

刀片外形 Insert Shape	型号 Type	基本尺寸 Dimensions(mm)				涂层牌号 Grade				
		IC	S	D1	BS	OP1215	OP1315	OP1325	OP1630	OP2202
	SNMX1205ANN-OM	12.7	6.2	6	2.1	●	▲			●
	SNMX1205ANN-OR	12.7	6.35	6	2.1	●	▲			●
	SNMX1205ZNN-OM	12.7	6.64	6	1.3	●	▲			●
	SNMX1205ZNN-OR	12.7	6.76	6	1.3	●	▲			●

▲主推牌号 ●可选牌号 ▲Featured grade ●Optional grade



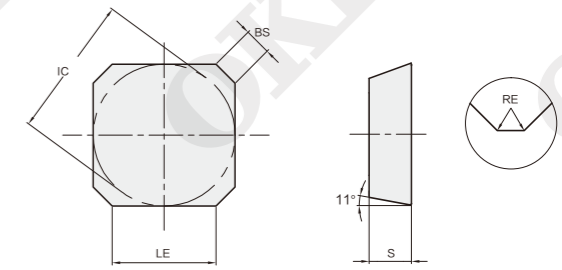

刀片外形 Insert Shape	型号 Type	基本尺寸 Dimensions(mm)					涂层牌号 Grade				
		LE	IC	S	D1	BS	OP1215	OP1315	OP1325	OP1630	OP2202
	SPKN1203EDSKR	12.7	12.7	3.18		1.481	●	▲			●
	SPKN1203EDSKL	12.7	12.7	3.18		1.481	●	▲			●
	SPKN1504EDL	15.875	15.875	4.76		1.35	●	▲			●
	SPKN1504EDR	15.875	15.875	4.76		1.35	●	▲			●
	SPKN1504EDS11PL	15.875	15.875	4.76		1.068	●	▲			●
	SPKN1504EDS11PR	15.875	15.875	4.76		1.068	●	▲			●



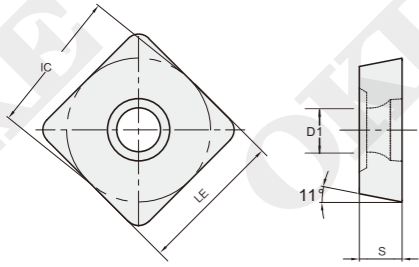

刀片外形 Insert Shape	型号 Type	基本尺寸 Dimensions(mm)					涂层牌号 Grade				
		IC	LE	S	D1	BS	OP1215	OP1315	OP1325	OP1630	OP2202
	SPKR1504EDL-YR	15.875	11.64	4.51		1.25	●	▲			●
	SPKR1504EDR-YR	15.875	11.64	4.51		1.25	●	▲			●

▲主推牌号 ●可选牌号 ▲Featured grade ●Optional grade

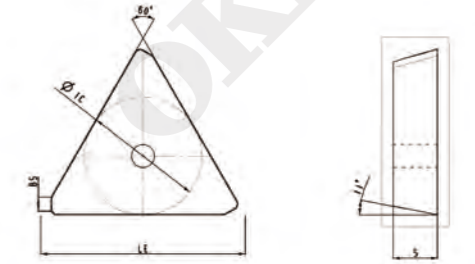

刀片外形 Insert Shape	型号 Type	基本尺寸 Dimensions(mm)					涂层牌号 Grade				
		LE	IC	S	D1	RE	OP1215	OP1315	OP1325	OP1630	OP2202
	SPMT090308	9.525	9.525	3.18	3.5	0.8	●	▲			●
	SPMT120408-HT-1	12.7	12.7	4.76	5.5	0.8	●	▲		●	



刀片外形 Insert Shape	型号 Type	基本尺寸 Dimensions(mm)				涂层牌号 Grade				
		IC	LE	S	BS	OP1215	OP1315	OP1325	OP1630	OP2202
	TPKN2204PDSR-Q1	12.7	22	4.76	1.51	▲	▲			●
	TPKN2204PDTR-Q1	22	22	4.76	1.51	▲	▲			●

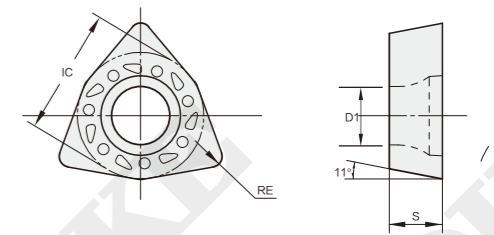

刀片外形 Insert Shape	型号 Type	基本尺寸 Dimensions(mm)				涂层牌号 Grade				
		IC	RE	S	D1	OP1215	OP1315	OP1325	OP1630	OP2202
	WPGT080615ZSR	12.85	1.5	6.35	5.5	●	▲			●

▲主推牌号 ●可选牌号 ▲Featured grade ●Optional grade

## 铣削刀具命名规则 Milling Tools Naming Rule



### 刀具类型 Type of Tools

FM 45 2 A22 63 5 SN13 L

FM	LM	SM	HM	RM	CM
面铣/方肩铣 Face milling Quare-shoulder milling	螺旋立铣刀 Indexable Helical Milling Tool	三面刃铣 Slot milling	快进给 High feed	仿形铣 Profiling tool	倒角铣 Chamfer milling

### 主偏角 Lead Angle

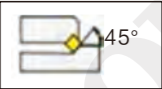
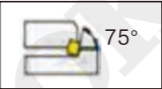
FM 45 2 A22 63 5 SN13 L

45°	75°	90°
		

### 区别代码 Differentiate Code

FM 45 2 A22 63 5 SN13 L

### 刀具加工部分直径 Cutting Tool Diameter

FM 45 2 A22 63 5 SN13 L

## 铣削刀具命名规则 Milling Tools Naming Rule

### 刀具安装部位结构 Adaptor Type

FM 45 2 A22 63 5 SN13 L

A	B	C	D	P	W	MT
A型接口 A interface	B型接口 B interface	C型接口 C interface	D型接口 D interface	圆形直柄 Cylindrical shank	侧固式 Lateral solid	莫氏锥柄 Morse taper shank

### 齿数 Teeth Number

FM 45 2 A22 63 5 SN13 L

### 刀片规格 Type

FM 45 2 A22 63 5 SN13 L

### 切削方向: 右刀R缺省, 左刀L Cutting Direction: Right/Left

FM 45 2 A22 63 5 SN13 L

### 套式结构 Shell Structure

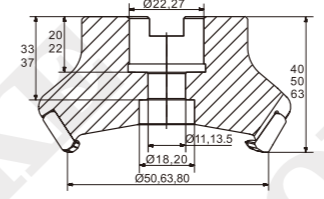
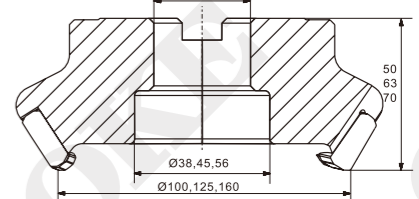
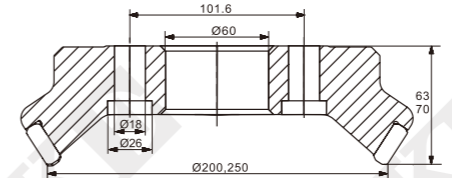
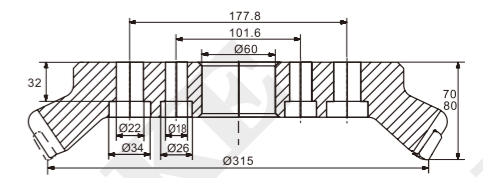
A型接口 Type of Adapter		B型接口 Type of Adapter	
	GB5342-96规定的 $\phi 50-\phi 80$ 套式面铣刀 GB5342-96 of $\phi 50-\phi 80$ shell Facemilling Cutter		GB5342-96规定的 $\phi 100-\phi 160$ 套式面铣刀 GB5342-96 of $\phi 100-\phi 160$ shell Facemilling Cutter
C型接口 Type of Adapter		D型接口 Type of Adapter	
	GB5342-96规定的 $\phi 200-\phi 250$ 套式面铣刀 GB5342-96 of $\phi 200-\phi 250$ shell Facemilling Cutter		GB5342-96规定的 $\phi 315$ 及以上的套式面铣刀 GB5342-96 of $\phi 315$ Facemilling Cutter



## 面铣刀具 Face Milling Tool

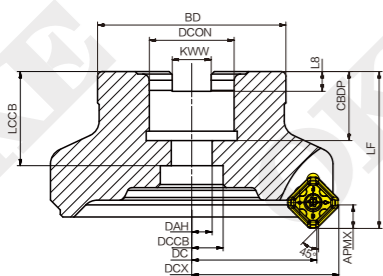

型号 Type	刃数 Edge	DC	DCX	LF	DCON	CBDP	LCCB	DAH	DCCB	BD	KWW	L8	APMX	重量 Weight	接口 形式 Inter Face
FM451A-A22-50-4-SE12	4	50	62.4	40	22	20		11		40	10.4	6.3	6	0.3	A
FM451A-A22-63-5-SE12	5	63	75.4	40	22	20		11		50	10.4	6.3	6	0.5	A
FM451A-A27-80-6-SE12	6	80	92.4	50	27	22		13		60	12.4	7	6	1.3	A
FM451A-B32-100-7-SE12	7	100	112.4	50	32		28		45	70	14.4	8	6	1.8	B
FM451A-B40-125-8-SE12	8	125	137.4	63	40		35		56	80	16.4	9	6	3.1	B
FM451A-C40-160-10-SE12	10	160	172.4	63	40		35		56	100	16.4	9	6	5.1	C
FM451A-C60-200-12-SE12	12	200	212.4	63	60		32		150	160	25.7	14	6	6.8	C
FM451A-C60-250-14-SE12	14	250	262.4	63	60		32		190	200	25.7	14	6	11.2	C
FM451A-D60-315-18-SE12	18	315	327.4	70	60		32		250	270	25.7	14	6	20.8	D



### 刀具附件 Accessories

适用刀片 Applicable Insert	刀垫 Shim	螺套 Thread Sleeve	刀片螺钉 Insert Screw	扳手 Wrench	扳手 Wrench
SE□T12T3 P151	S13BS	SM0507	TL60 M3.5 × 10	T15T	S3.5

## 面铣刀具 Face Milling Tool

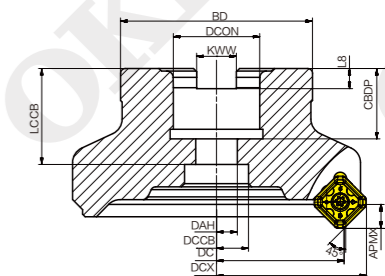

型号 Type	刃数 Edge	DC	DCX	LF	DCON	CBDP	LCCB	DAH	DCCB	BD	KWW	L8	APMX	重量 Weight	接口 形式 Inter Face
FM451A-A22-50-3-SE12	3	50	62.4	40	22	20		11		40	10.4	6.3	6	0.3	A
FM451A-A22-63-4-SE12	4	63	75.4	40	22	20		11		50	10.4	6.3	6	0.5	A
FM451A-A27-80-4-SE12	4	80	92.4	50	27	22		13		60	12.4	7	6	1.2	A
FM451A-B32-100-5-SE12	5	100	112.4	50	32		28		45	70	14.4	8	6	1.8	B
FM451A-B40-125-6-SE12	6	125	137.4	63	40		35		56	80	16.4	9	6	3.55	B





疏齿不等齿距

### 刀具附件 Accessories

适用刀片 Applicable Insert	刀垫 Shim	螺套 Thread Sleeve	刀片螺钉 Insert Screw	扳手 Wrench	扳手 Wrench
SE□T12T3 P151	S13BS	SM0508	TL60 M3.5 × 10	T15T	S3.5

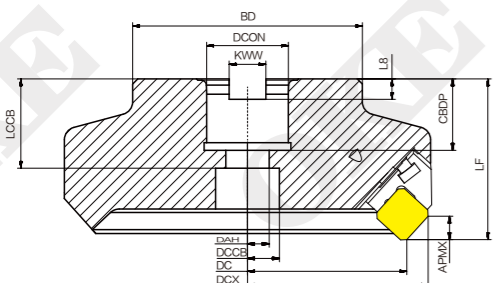
## 面铣刀具 Face Milling Tool





型号 Type	刃数 Edge	DC	DCX	LF	DCON	CBDP	LCCB	DAH	DCCB	BD	KWW	L8	APMX	重量 Weight	接口 形式 Inter Face
 FM451B-B27-80-4-SE12	4	80	103	50	27	22		13		60	12.4	7	5.5	1.8	A
FM451B-B32-100-5-SE12	5	100	122	50	32		28		45	80	14.4	8	5.5	2.4	B
FM451B-B40-125-6-SE12	6	125	147	63	40		35		56	80	16.4	9	5.5	4.4	B
FM451B-B40-160-8-SE12	8	160	181	63	40		35		56	100	16.4	9	5.5	6.4	B
FM451B-C60-200-10-SE12	10	200	221	63	60					160	25.7	14	5.5	8.5	C
FM451B-C60-250-12-SE12	12	250	270	63	60				180	200	25.7	14	5.5	14.1	C
FM451B-D60-315-15-SE12	15	315	353	63	60				230	250	25.7	14	5.5	22.2	D

### 刀具附件 Accessories

适用刀片 Applicable Insert	刀夹 Tools Chuck	压块 Clamp	双头螺钉 Double Headed Screw	刀夹螺钉 Tools Chuck Screw	扳手 Wrench
SE□N1203 P152	LSE12R/L	W01R/L	DM8 × 21X	LOM5 × 15.1	S3

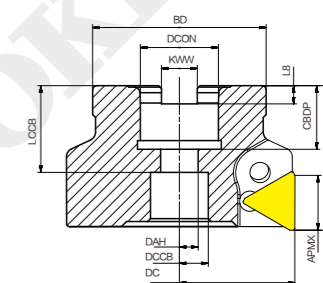
## 方肩铣刀 Square Shoulder Milling



型号 Type	刃数 Edge	DC	LF	DCON	CBDP	LCCB	DAH	DCCB	BD	KWW	L8	APMX	重量 Weight	接口 形式 Inter Face
 FM901A-A22-63-3-TP22	3	63	50	22	20		11		50	10.4	6.3	15	0.5	A
FM901A-A27-80-4-TP22	4	80	50	27	22		13		60	12.4	7	15	0.9	A
FM901A-A32-100-5-TP22	5	100	50	32		28		45	70	14.4	8	15	1.8	B
FM901A-B40-125-6-TP22	6	125	63	40		35		56	80	16.4	9	15	2.5	B
FM901A-B40-160-7-TP22	7	160	63	40		35		56	100	16.4	9	15	3.6	B

### 刀具附件 Accessories

适用刀片 Applicable Insert	刀片螺钉 Insert Screw	扳手 Wrench
TPKN2204 P158	MYL8 × 18	S4

## 方肩铣刀 Square Shoulder Milling

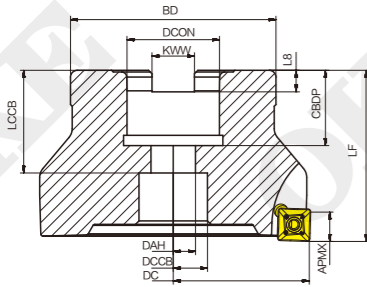

型号 Type	刃数 Edge	DC	LF	DCON	CBDP	LCCB	DAH	DCCB	BD	KWW	L8	APMX	重量 Weight	接口 形式 Inter Face
FM901B-A22-50-5-SE09	5	50	40	22	20		11		40	10.4	6.3	6.5	0.3	A
FM901B-A22-63-6-SE09	6	63	40	22	20		11		50	10.4	6.3	6.5	0.5	A
FM901B-A27-80-8-SE09	8	80	50	27	22		13		60	12.4	7	6.5	0.9	A
FM901B-B32-100-8-SE09	8	100	50	32		28		45	70	14.4	8	6.5	1.8	B
FM901B-B32-100-10-SE09	10	100	50	32		28		45	70	14.4	8	6.5	2.5	B
FM901B-B40-125-12-SE09	12	125	63	40		35		56	80	16.4	9	6.5	3.6	B



### 刀具附件 Accessories

适用刀片 Applicable Insert	刀片螺钉 Insert Screw	扳手 Wrench
SEET09T308PER P152	TL60 M3×7	T08T

## 方肩铣刀 Square Shoulder Milling

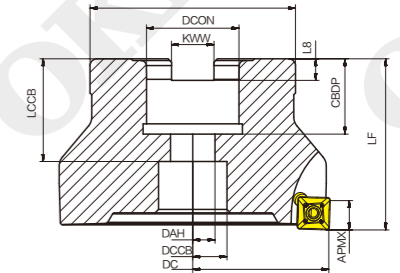

型号 Type	刃数 Edge	DC	LF	DCON	CBDP	LCCB	DAH	DCCB	BD	KWW	L8	APMX	重量 Weight	接口 形式 Inter Face
FM901B-A22-50-3-SE12	3	50	40	22	20		11		40	10.4	6.3	10	0.3	A
FM901B-A22-63-4-SE12	4	63	40	22	20		11		50	10.4	6.3	10	0.65	A
FM901B-A27-80-4-SE12	4	80	50	27	22		13		60	12.4	7	10	0.9	A
FM901B-B32-100-5-SE12	5	100	50	32		28		45	70	14.4	8	10	1.2	B
FM901B-B40-125-6-SE12	6	125	63	40		35		56	80	16.4	9	10	3.1	B
FM901B-C40-160-8-SE12	8	160	63	40		35		112	100	16.4	9	10	4.1	C
FM901B-C60-200-10-SE12	10	200	63	60		32		150	140	25.7	14	10	6.1	C
FM901B-C60-250-12-SE12	12	250	63	60		32		215	200	25.7	14	10	10.9	C
FM901B-A22-50-4-SE12	4	50	40	22	20		11		40	10.4	6.3	10	0.3	A
FM901B-A22-63-5-SE12	5	63	40	22	20		11		50	10.4	6.3	10	0.65	A
FM901B-A27-80-6-SE12	6	80	50	27	22		13		60	12.4	7	10	0.9	A
FM901B-B32-100-7-SE12	7	100	50	32		28		45	70	14.4	8	10	1.2	B
FM901B-B40-125-8-SE12	8	125	63	40		35		56	80	16.4	9	10	3.1	B
FM901B-C40-160-12-SE12	12	160	63	40		35		112	100	16.4	9	10	4.1	C
FM901B-A22-50-5-SE12	5	50	40	22	20		11		40	10.4	6.3	10	0.3	A
FM901B-A22-63-6-SE12	6	63	40	22	20		11		50	10.4	6.3	10	0.65	A
FM901B-A27-80-8-SE12	8	80	50	27	22		13		60	12.4	7	10	0.9	A
FM901B-B32-100-10-SE12	10	100	50	32		28		45	70	14.4	8	10	1.2	B
FM901B-B40-125-12-SE12	12	125	63	40		35		56	80	16.4	9	10	3.1	B
FM901B-C40-160-14-SE12	14	160	63	40		35		112	100	16.4	9	10	4.1	C
FM901B-C60-200-16-SE12	16	200	63	60		32		150	140	25.7	14	10	6.1	C
FM901B-C60-250-18-SE12	18	250	63	60		32		215	200	25.7	14	10	10.9	C
FM901B-D60-315-24-SE12	24	315	63	60		32		260	250	25.7	14	10	21.6	D



### 刀具附件 Accessories

适用刀片 Applicable Insert	刀垫 Shim	螺套 Thread Sleeve	刀片螺钉 Insert Screw	扳手 Wrench	扳手 Wrench
SEET120308PER P152	S12BSX	SM0508	TL60 M3.5×10	T15T	S3.5

## 方肩铣刀 Square Shoulder Milling

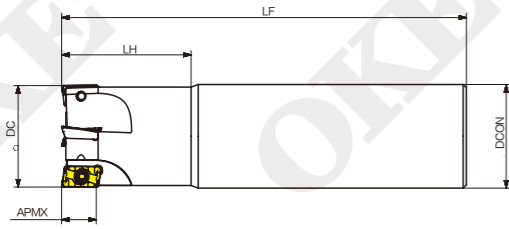

型号 Type	刃数 Edge	DC	LH	LF	DCON	APMX	重量 Weight	接口 形式 Inter Face
FM901C-P16-12-1-AP11-85	1	12	25	85	16	10.5	0.1	P
FM901C-P16-16-2-AP11-90	2	16	25	90	16	10.5	0.1	P
FM901C-P20-20-2-AP11-100	2	20	30	100	20	10.5	0.2	P
FM901C-P25-25-3-AP11-115	3	25	35	115	25	10.5	0.4	P
FM901C-P32-32-4-AP11-125	4	25	40	125	32	10.5	0.7	P
FM901C-W16-12-1-AP11-85	1	12	25	85	16	10.5	0.1	W
FM901C-W16-16-2-AP11-90	2	16	25	90	16	10.5	0.1	W
FM901C-W20-20-2-AP11-100	2	20	30	100	20	10.5	0.2	W
FM901C-W25-25-3-AP11-115	3	25	35	115	25	10.5	0.4	W
FM901C-W32-32-4-AP11-125	4	25	40	125	32	10.5	0.7	W
FM901C-P25-25-2-AP16-115	2	25	35	115	16	10.5	0.4	P
FM901C-P32-32-3-AP16-125	3	32	40	125	20	10.5	0.7	P
FM901C-P32-40-4-AP16-130	4	40	42	130	25	10.5	0.8	P
FM901C-W25-25-2-AP16-115	2	25	35	115	16	10.5	0.4	W
FM901C-W32-32-3-AP16-125	3	32	40	125	20	10.5	0.7	W
FM901C-W32-40-4-AP16-130	4	40	42	130	25	10.5	0.8	W



### 刀具附件 Accessories

适用刀片 Applicable Insert	刀片螺钉 Insert Screw	扳手 Wrench
APMT11T3□□ P147	TL60 M2.5×6.5	T08
APMT1604□□ P147	TL60 M4×10	T15

## 方肩铣刀 Square Shoulder Milling

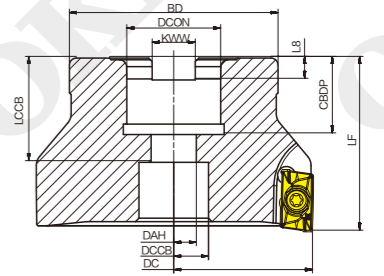

型号 Type	刃数 Edge	DC	LF	DCON	CBDP	LCCB	DAH	DCCB	BD	KWW	L8	APMX	重量 Weight	接口 形式 Inter Face
FM901C-A22-50-6-AP11	6	50	40	22	20		11		40	10.4	6.3	11	0.3	A
FM901C-A22-63-8-AP11	8	63	40	22	20		11		50	10.4	6.3	11	0.6	A
FM901C-A27-80-8-AP11	8	80	50	27	22		13		60	12.4	7	11	1.2	A
FM901C-B32-100-10-AP11	10	100	50	32		28		45	60	14.4	8	11	1.7	B
FM901C-A22-50-5-AP16	5	50	40	22	20		11		40	10.4	6.3	15.5	0.3	A
FM901C-A22-63-6-AP16	6	63	40	22	20		11		50	10.4	6.3	15.5	0.5	A
FM901C-A27-80-7-AP16	7	80	50	27	22		13		60	12.4	7	15.5	1.1	A
FM901C-B32-100-8-AP16	8	100	50	32		28		45	70	14.4	8	15.5	1.6	B
FM901C-B40-125-10-AP16	10	125	63	40		35		56	80	16.4	9	15.5	3.2	B
FM901C-B40-160-10-AP16	10	160	63	40		35		56	100	16.4	9	15.5	3.2	B



### 刀具附件 Accessories

适用刀片 Applicable Insert	刀片螺钉 Insert Screw	扳手 Wrench
APMT11T3□□ P147	TL60 M2.5×6.5	T08
APMT1604□□ P147	TL60 M4×10	T15

## 方肩铣刀 Square Shoulder Milling

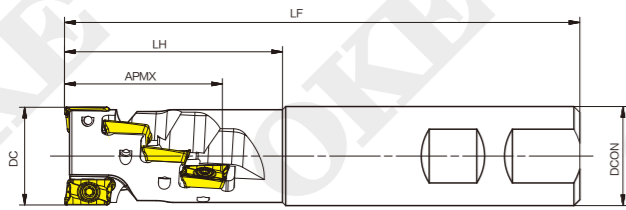



型号 Type	刃数 Edge	DC	LH	LF	DCON	APMX	重量 Weight	接口 形式 Inter Face
 FM901D-W20-20-1-AP11-29	1	20	45	120	20	29	0.3	W
FM901D-W25-25-2-AP11-39	2	25	55	130	25	39	0.4	W
FM901D-W32-32-2-AP11-48	2	32	65	140	32	48	0.7	W
FM901D-W32-40-2-AP11-55	2	40	75	150	32	55	1.3	W

### 刀具附件 Accessories

适用刀片 Applicable Insert	刀片螺钉 Insert Screw	扳手 Wrench
APMT11T3□□ P147	TL60 M2.5 × 6.5	T08

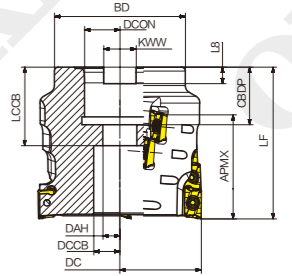
## 方肩铣刀 Square Shoulder Milling





型号 Type	刃数 Edge	DC	LF	DCON	CDBP	LCCB	DAH	DCCB	BD	KWW	L8	APMX	重量 Weight	接口 形式 Inter Face
 FM901D-A22-50-4-AP11-39	4	50	58	22	20		11		40	10.4	6.3	39	0.5	A
FM901D-A27-63-4-AP11-39	4	63	58	27	22		13		50	12.4	7	39	0.9	A
FM901D-B32-80-5-AP11-39	5	80	63	32		28		45	60	14.4	8	39	1.3	B
FM901D-B40-100-6-AP11-39	6	100	63	40		35		56	70	16.4	9	39	2.1	B

### 刀具附件 Accessories

适用刀片 Applicable Insert	刀片螺钉 Insert Screw	扳手 Wrench
APMT11T3□□ P147	TL60 M2.5 × 6.5	T08T

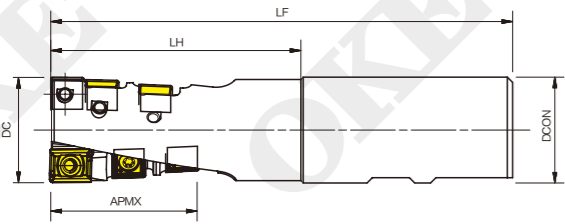
## 螺旋立铣刀 Indexable Helical Milling Tool





型号 Type	刃数 Edge	DC	LH	LF	DCON	APMX	重量 Weight	接口形式 Inter Face
 LM901-W40-40-2-SP12-55	2	40	95	175	40	55	1.2	W
LM901-W40-50-4-SP12-55	4	50	95	175	40	55	1.5	W

### 刀具附件 Accessories

适用刀片 Applicable Insert	侧切刀片 Side Cutting Insert	刀片螺钉 Insert Screw	扳手 Wrench
APKT150412 P146	SPMT120408	TL60 M5 × 12	T20

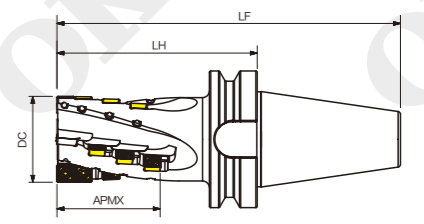
## 螺旋立铣刀 Indexable Helical Milling Tool





型号 Type	刃数 Edge	DC	LH	LF	APMX	重量 Weight	接口形式 Inter Face
 LM901-JT50-50-4-SP12-84	4	50	145	246.75	84	4.8	JT50
LM901-JT50-63-4-SP12-74	4	63	135	236.75	74	5.5	JT50
LM901-JT50-63-4-SP12-104	4	63	165	266.75	104	6.1	JT50
LM901-JT50-63-4-SP12-134	4	63	195	296.75	134	6.3	JT50
LM901-JT50-80-4-SP12-104	4	80	165	266.75	104	6.9	JT50
LM901-JT50-80-4-SP12-144	4	80	205	306.75	144	7.2	JT50
LM901-BT50-50-4-SP12-84	4	50	145	246.75	84	4.8	BT50
LM901-BT50-63-4-SP12-74	4	63	135	236.75	74	5.5	BT50
LM901-BT50-63-4-SP12-104	4	63	165	266.75	104	6.1	BT50
LM901-BT50-63-4-SP12-134	4	63	195	296.75	134	6.3	BT50
LM901-BT50-80-4-SP12-104	4	80	165	266.75	104	6.9	BT50
LM901-BT50-80-4-SP12-144	4	80	205	306.75	144	7.2	BT50

### 刀具附件 Accessories

适用刀片 Applicable Insert	侧切刀片 Side Cutting Insert	刀片螺钉 Insert Screw	扳手 Wrench
APKT150412 P146	SPMT120408	TL60 M5 × 12	T20

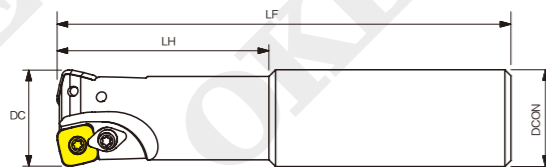
## 大进给刀具 High Feed Milling





型号 Type	刃数 Edge	DC	LH	LF	DCON	APMX	重量 Weight	接口形式 Inter Face
 HM101-P25-25-2-SD09-140	2	25	60	140	25		0.5	P
HM101-P32-32-3-SD09-150	3	32	70	150	32		0.8	P
HM101-P32-35-3-SD09-150	3	35	50	150	32		0.8	P
HM101-P32-32-2-SD12-150	2	32	70	150	32		0.8	P
HM101-P32-40-3-SD12-150	3	40	50	150	32		1.3	P

### 刀具附件 Accessories

适用刀片 Applicable Insert	刀片螺钉 Insert Screw	压板螺丝 Screw Clamp	压板 Pressing Plate	扳手 Wrench
SDMT09T3 <span style="color: green;">P150</span>	TL60 M3.5 × 8	L60 M4 × 10	WD204	T10/T15
SDMT1204 <span style="color: green;">P150</span>	TL60 M4 × 10			T15

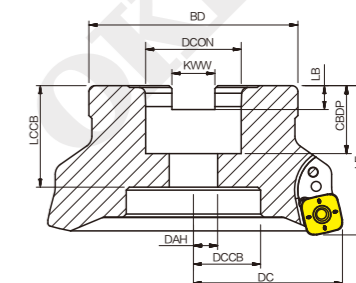
## 大进给刀具 High Feed Milling



型号 Type	刃数 Edge	DC	LF	DCON	DCBP	LCCB	DAH	DCCB	BD	KWW	L8	APMX	重量 Weight	接口形式 Inter Face
 HM101-A22-50-4-SD09	4	50	40	22	20		11	40	10.4	6.3			0.3	A
HM101-A22-63-6-SD09	6	63	50	22	20		11	50	10.4	6.3			0.5	A
HM101-A27-63-6-SD09	6	63	50	27	22		13	50	12.4	7			0.6	A
HM101-A22-63-5-SD12	5	63	50	22	20		11	50	10.4	6.3			0.5	A
HM101-A27-63-5-SD12	5	63	50	27	22		13	50	12.4	7			0.6	A
HM101-A27-80-5-SD12	5	80	50	27	22		13	60	12.4	7			0.9	A
HM101-A32-100-6-SD12	6	100	50	32		28	45	70	14.4	8			1.8	B

### 刀具附件 Accessories

适用刀片 Applicable Insert	刀片螺钉 Insert Screw	压板螺丝 Screw Clamp	压板 Pressing Plate	扳手 Wrench
SDMT09T3 <span style="color: green;">P150</span>	TL60 M3.5 × 8	L60 M4 × 10	WD204	T10/T15
SDMT1204 <span style="color: green;">P150</span>	TL60 M4 × 10			T15

## 大进给刀具 High Feed Milling

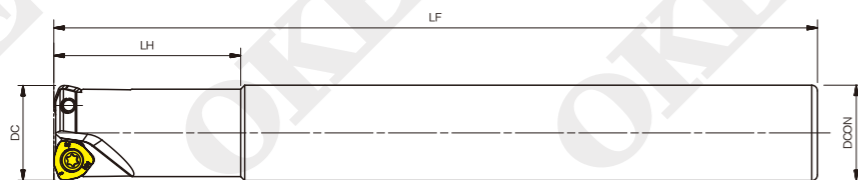

型号 Type	刃数 Edge	DC	LH	LF	DCON	APMX	重量 Weight	接口 形式 Inter Face
HM221-P25-25-2-WP06-140	2	25	60	140	25		0.4	P
HM221-P25-25-2-WP06-200	2	25	120	200	25		0.6	P
HM221-P25-25-2-WP06-300	2	25	180	300	25		0.9	P
HM221-P32-32-3-WP06-150	3	32	70	150	32		0.8	P
HM221-P32-32-3-WP06-200	3	32	120	200	32		0.9	P
HM221-P32-32-3-WP06-300	3	32	180	300	32		1.6	P
HM221-P32-40-3-WP08-150	3	40	50	150	32		0.9	P
HM221-P32-40-3-WP08-200	3	40	50	200	32		1.5	P
HM221-P32-40-3-WP08-300	3	40	50	300	32		1.8	P
HM221-P32-40-2-WP08-150	2	40	50	150	32		0.9	P
HM221-P32-40-2-WP08-200	2	40	50	200	32		1.5	P
HM221-P32-40-2-WP08-300	2	40	50	300	32		1.9	P

### 刀具附件 Accessories

适用刀片 Applicable Insert	刀片螺钉 Insert Screw	压板螺丝 Screw Clamp	压板 Pressing Plate	扳手 Wrench	
WPGT080615ZSR	P158	TL60 M4 × 10	L60 M5 × 12	WD208	T20

## 大进给刀具 High Feed Milling

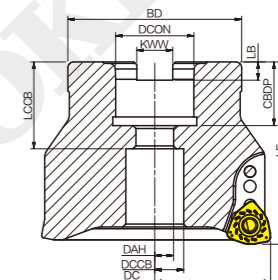

型号 Type	刃数 Edge	DC	LF	DCON	CBDP	LCCB	DAH	DCCB	BD	KWW	L8	APMX	重量 Weight	接口 形式 Inter Face
HM221-A22-50-4-WP06	4	50	50	22	20		11		40	10.4	6.3		0.4	A
HM221-A22-50-3-WP08	3	50	50	22	20		11		40	10.4	6.3		0.4	A
HM221-A22-63-4-WP08	4	63	50	22	20		11		50	10.4	6.3		0.7	A
HM221-A27-63-4-WP08	4	63	50	27	22		13		50	12.4	7		0.7	A
HM221-A27-80-5-WP08	5	80	50	27	22		13		60	12.4	7		1.5	A
HM221-B32-100-6-WP08	6	100	63	32		28		45	70	14.4	8		2.2	B
HM221-B40-125-7-WP08	7	125	63	40		35		56	80	16.4	9		3.5	B
HM221-B40-160-8-WP08	8	160	63	40		35		56	100	16.4	9		5.9	B

### 刀具附件 Accessories

适用刀片 Applicable Insert	刀片螺钉 Insert Screw	压板螺丝 Screw Clamp	压板 Pressing Plate	扳手 Wrench	
WPGT080615ZSR	P158	TL60 M5 × 12	TL60 M5 × 12	WD208	T20T



## 仿形铣刀具 Profiling Tool

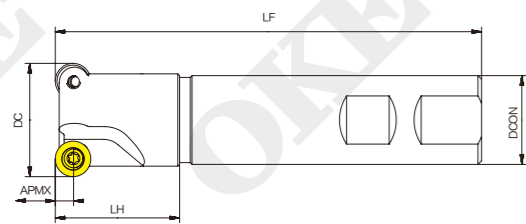



型号 Type	刃数 Edge	DC	LH	LF	DCON	APMX	重量 Weight	接口形式 Inter Face
 RM01-W32-40-3-RC12-120	3	40	40	120	32	6	0.7	W
RM01-W32-50-5-RC12-120	5	50	40	120	32	6	0.8	W

### 刀具附件 Accessories

适用刀片 Applicable Insert	刀片螺钉 Insert Screw	扳手 Wrench
RCKT1204MO	P148	TL60 M4 × 10

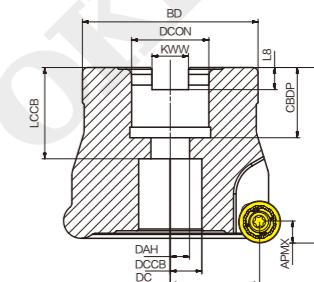
## 仿形铣刀具 Profiling Tool





型号 Type	刃数 Edge	DC	DCX	LF	DCON	CBDP	LCCB	DAH	DCCB	BD	KWW	L8	APMX	重量 Weight	接口形式 Inter Face
 RM01-A22-63-4-RC12	4	63	50	50	22	20		11		50	10.4	6.3	6	0.7	A
RM01-B27-80-5-RC12	5	80	50	50	27		30		38	60	12.4	7	8	0.7	B
RM01-B32-100-6-RC16	6	100	50	50	32		28		45	70	14.4	8	8	1.2	B
RM01-B40-125-7-RC16	7	125	63	63	40		35		56	80	16.4	9	10	2.2	B

### 刀具附件 Accessories

适用刀片 Applicable Insert	刀片螺钉 Insert Screw	扳手 Wrench
RCKT1204MO-OPR	P148	TL60 M4 × 10
RCKT1606MO-OPR	P148	TL60 M5 × 13

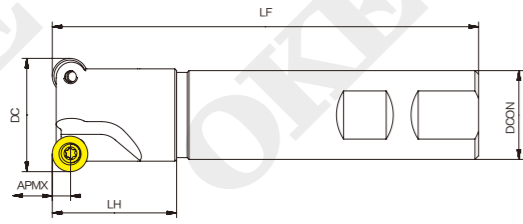
## 仿形铣刀具 Profiling Tool





型号 Type	刃数 Edge	DC	LH	LF	DCON	APMX	重量 Weight	接口 形式 Inter Face
 RM02-W16-16-2-RD08-100	2	16	25	100	16	4	0.1	W
RM02-W25-25-2-RD08-100	2	25	30	100	25	4	0.3	W
RM02-W32-32-2-RD10-120	2	32	40	120	32	5	0.7	W
RM02-W32-40-3-RD12-120	3	40	40	120	32	6	0.7	W
RM02-W32-50-4-RD12-120	4	50	40	120	32	6	0.8	W

### 刀具附件 Accessories

适用刀片 Applicable Insert	刀片螺钉 Insert Screw	扳手 Wrench
RDKW10T3MO	P148 TL60 M4 × 10	T15
RDKW1204MO	P148 TL60 M4 × 10	T15

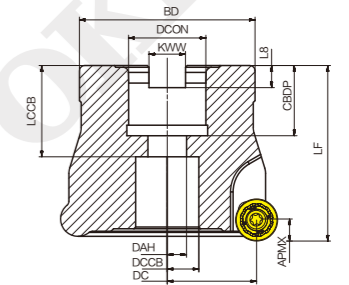
## 仿形铣刀具 Profiling Tool





型号 Type	刃数 Edge	DC	LF	DCON	CDBP	LCCB	DAH	DCCB	BD	KWW	L8	APMX	重量 Weight	接口 形式 Inter Face
 RM02-A22-50-3-RD12	3	50	50	22	20		11		40	10.4	6.3	6	0.3	A
RM02-A22-63-4-RD12	4	63	50	22	20		11		50	10.4	6.3	6	0.5	A
RM02-B27-80-5-RD16	5	80	50	27		30		38	60	12.4	7	8	1.2	B
RM02-B32-100-6-RD16	6	100	50	32		28		45	70	14.4	8	8	1.6	B
RM02-B40-125-6-RD20	6	125	63	40		35		56	80	16.4	9	10	1.9	B
RM02-B40-160-7-RD20	7	160	63	40		35		56	100	16.4	9	10	3.7	B

### 刀具附件 Accessories

适用刀片 Applicable Insert	刀片螺钉 Insert Screw	压板 Pressing Plate	扳手 Wrench
RDKW1204MO	P148 TL60 M4 × 10	WD204	T15T
RDKW1605MO	P148 TL60 M5 × 12	WD208	T20T
RDKW2006MO	P148 TL60 M6 × 16		T25T

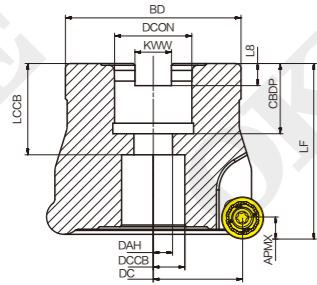
## 仿形铣刀具 Profiling Tool





型号 Type	刃数 Edge	DC	LF	DCON	CBDP	LCCB	DAH	DCCB	BD	KWW	L8	APMX	重量 Weight	接口 形式 Inter Face
 RM03-A22-50-4-RP12	4	50	40	22	20		11		40	10.4	6.3	6	0.4	A
RM03-A22-63-5-RP12	5	63	45	22	20		11		50	10.4	6.3	6	0.7	A
RM03-B27-80-6-RP12	6	80	50	27		30		38	60	12.4	7	8	1.2	B
RM03-A22-63-4-RP16	4	63	50	22	20		11		40	10.4	6.3	8	0.7	A
RM03-A27-80-5-RP16	5	80	50	27	22		13		60	12.4	7	8	1.2	A
RM03-B32-100-6-RP16	6	100	63	32		28		45	70	14.4	8	8	1.6	B

### 刀具附件 Accessories

适用刀片 Applicable Insert	刀片螺钉 Insert Screw	压板 Pressing Plate	扳手 Wrench
RP□□1204MO P149	TL60 M4 × 10	WD204	T15T

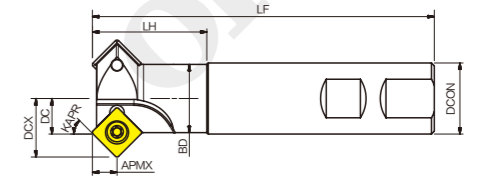
## 倒角铣刀 Chamfer Milling Tool



型号 Type	刃数 Edge	KAPR	DC	DCX	LH	LF	DCON	BD	APMX	重量 Weight	接口 形式 Inter Face
 CM451-P20-12-1-SP12-100	1	45	12	28.1	40	100	20	15	8.3	0.2	P
CM451-W20-12-1-SP12-100	1	45	12	28.1	40	100	20	15	8.3	0.2	W
CM451-P25-25-2-SP12-120	2	45	25	41.3	40	120	25	24	8.3	0.8	P
CM451-W25-25-2-SP12-120	2	45	25	41.3	40	120	25	24	8.3	0.6	W
CM451-P32-32-3-SP12-180	3	45	32	49.3	40	180	32	30	8.3	1.1	P
CM451-W32-32-3-SP12-180	3	45	32	49.3	40	180	32	30	8.3	1.1	W

### 刀具附件 Accessories

适用刀片 Applicable Insert	刀片螺钉 Insert Screw	扳手 Wrench
SPMT120408 P157	TL60 M5 × 13	T20

## 倒角铣刀 Chamfer Milling Tool

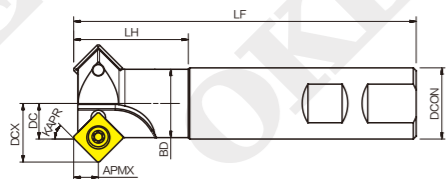

型号 Type	刃数 Edge	KAPR	DC	DCX	LH	LF	DCON	BD	APMX	重量 Weight	接口 形式 Inter Face
CM601-P20-12-1-SP12-100	1	30	12	23.3	40	100	20	14	9.5	0.2	P
CM601-W20-12-1-SP12-100	1	30	12	23.3	40	100	20	14	9.5	0.2	W
CM601-P25-25-2-SP12-120	2	30	25	36.3	40	120	25	20	9.5	0.8	P
CM601-W25-25-2-SP12-120	2	30	25	36.3	40	120	25	20	9.5	0.6	W
CM601-P32-32-2-SP12-180	2	30	32	43.3	40	180	32	26	9.5	1.1	P
CM601-W32-32-2-SP12-180	2	30	32	43.3	40	180	32	26	9.5	1.1	W

### 刀具附件 Accessories

适用刀片 Applicable Insert	刀片螺钉 Insert Screw	扳手 Wrench
SPMT120408	P157	TL60 M5 × 13

## 倒角铣刀 Chamfer Milling Tool

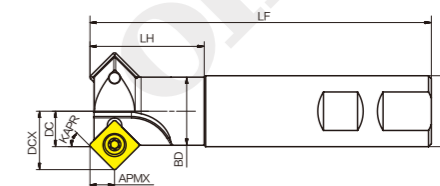

型号 Type	刃数 Edge	KAPR	DC	DCX	LH	LF	DCON	BD	APMX	重量 Weight	接口 形式 Inter Face
CM301-P20-12-1-SP12-100	1	60	12	32	40	100	20	19	5	0.2	P
CM301-W20-12-1-SP12-100	1	60	12	32	40	100	20	19	5	0.2	W
CM301-P25-25-2-SP12-120	2	60	25	45.4	40	120	25	24	5	0.8	P
CM301-W25-25-2-SP12-120	2	60	25	45.4	40	120	25	24	5	0.6	W
CM301-P32-32-3-SP12-180	3	60	32	52	50	180	32	30	5	1.1	P
CM301-W32-32-3-SP12-180	3	60	32	52	50	180	32	30	5	1.1	W

### 刀具附件 Accessories

适用刀片 Applicable Insert	刀片螺钉 Insert Screw	扳手 Wrench
SPMT120408	P157	TL60 M5 × 13